

BB5 : BB6

Right Angle Full Cone

The BB5 and BB6 nozzles feature a removable cup and a 90° spray from the inlet axis.

The BB6 is similar to the BB5 but has a wider spray angle.

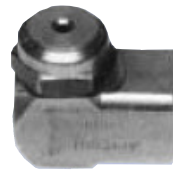

F-BB5

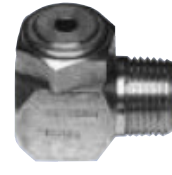

M-BB5



F-BB6



M-BB6

Construction

Brass or SS303

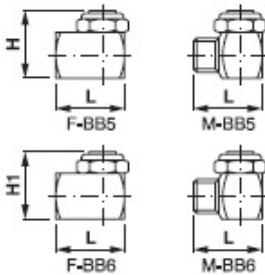

Ø	H max	H1 max	L
1/8"	21	23	23
1/4"	28	30	30
3/8"	30	34	33
1/2"	43	45	40

Model	Ø1 mm	Ø2 mm	Flow lpm @ bar										Spray angle @ bar		
			0.5	0.75	1	1.5	2	3	4	5	6	7	0.5	1.5	5
1/8 F/M-BB5-2	1.3	1.0	0.64	0.80	0.89	1.10	1.25	1.50	1.75	1.90	2.10	2.30	45	50	45
1/8 F/M-BB5-3	1.6	1.0	0.97	1.18	1.30	1.64	1.82	2.20	2.55	2.81	3.05	3.30	50	65	60
1/8 F/M-BB5-3.5	1.6	1.0	1.15	1.40	1.60	1.90	2.15	2.50	3.05	3.30	3.60	3.85	45	50	45
1/8 F/M-BB5-5	2.0	1.3	1.65	2.00	2.20	2.60	3.10	3.75	4.24	4.71	5.15	5.50	50	65	60
1/4 F/M-BB5-6.5	2.3	1.6	2.10	2.60	2.90	3.50	4.10	4.85	5.50	6.10	6.50	7.10	45	50	45
1/4 F/M-BB5-10	2.9	1.6	3.25	4.10	4.50	5.40	6.15	7.15	8.50	9.40	10.3	11.0	58	65	60
3/8 F/M-BB5-9.5	2.6	2.4	3.10	4.00	4.20	5.20	5.70	7.10	8.20	9.00	9.70	10.5	45	50	45
3/8 F/M-BB5-15	3.6	2.4	4.90	6.00	6.70	8.10	9.20	11.2	12.6	14.1	15.1	16.5	65	65	60
3/8 F/M-BB5-20	4.0	2.8	6.50	8.10	8.90	10.7	12.5	14.8	17.1	18.5	19.9	22.0	75	80	75
3/8 F/M-BB5-22	4.7	2.8	7.10	8.90	9.80	11.8	13.5	16.2	18.5	21.1	22.0	24.5	85	90	80
1/2 F/M-BB5-16	3.5	3.2	5.25	6.40	7.10	8.60	9.81	11.9	13.5	15.1	16.2	17.4	48	50	45
1/2 F/M-BB5-25	4.6	3.2	8.10	10.0	11.1	13.5	15.2	18.4	21.0	23.1	25.0	26.8	65	65	60
1/2 F/M-BB5-32	5.2	3.6	10.5	12.9	14.2	17.3	19.7	23.9	27.0	30.0	33.0	35.1	70	75	68
1/2 F/M-BB5-40	6.4	3.6	12.9	16.0	17.8	20.8	24.2	29.6	33.8	37.0	40.8	44.0	90	90	85
1/2 F/M-BB5-50	6.7	4.0	16.5	20.0	22.0	26.0	31.0	37.5	42.4	47.1	51.5	55.0	90	95	85
1/8 F/M-BB6-4.3	2.0	1.0	1.40	1.70	1.90	2.30	2.50	3.10	3.40	3.80	4.30	4.50	120	120	100
1/8 F/M-BB6-8	2.5	1.3	2.50	3.10	3.50	4.10	4.70	5.60	6.50	7.30	7.80	8.50	120	120	100
1/4 F/M-BB6-14	3.6	1.6	4.50	5.60	6.20	7.50	8.50	10.2	11.5	12.5	13.5	14.5	120	120	100
1/4 F/M-BB6-20	4.4	2.4	6.50	8.00	8.80	10.5	12.1	14.5	16.5	18.1	19.4	21.0	120	120	105
1/2 F/M-BB6-35	5.9	3.2	11.4	14.0	15.5	18.5	21.0	24.8	29.0	30.9	34.0	36.0	120	120	110
1/2 F/M-BB6-50	6.7	4.0	16.3	20.0	22.0	25.8	30.0	36.3	41.0	45.1	48.9	52.0	120	120	110

