

KSY Side Spray Nozzles

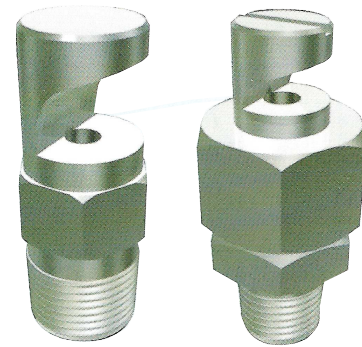

The KSY is a multi-purpose nozzle that is lower in impact compared to flat spray nozzles.

It can be used in the washing of conveyors, films, eliminator plates, sheet glass, etc., the cooling of conveyors, roofs and tanks, and for fire prevention, heat shielding, deodorisation, and dust prevention.



Characteristics

Wide spray angle.

Simple structure meaning improved clog resistance.

Interchangeable tips.

Construction

Constructed from SS303, brass, PTFE, PVC, or PP

Con-necting threads	Model			Model number	Minimum orifice diameter	Flow rate l/min @ bar							Spray angle @ bar		
	R threads					1	2	3	4	5	7	10	1	3	10
	KSY	KSYL	KSAY												
1/8"	•	•	•	01	1.1	0.58	0.82	1.00	1.15	1.29	1.53	1.83	127°	140°	148°
	•	•	•	015	1.2	0.87	1.22	1.50	1.73	1.94	2.3	2.7	127°	140°	148°
	•	•	•	02	1.4	1.15	1.63	2.0	2.3	2.6	3.1	3.7	128°	140°	147°
	•	•	•	03	1.7	1.73	2.4	3.0	3.5	3.9	4.6	5.5	128°	140°	147°
1/4"	•	•	•	04	2.0	2.3	3.3	4.0	4.6	5.2	6.1	7.3	128°	140°	147°
	•	•	•	06	2.4	3.5	4.9	6.0	6.9	7.7	9.2	11.0	128°	140°	147°
	•	•	•	08	2.9	4.6	6.5	8.0	9.2	10.3	12.2	14.6	128°	140°	147°
	•	•	•	10	3.1	5.8	8.2	10.0	11.5	12.9	15.3	18.3	128°	140°	147°
	•	•	•	15	3.9	8.7	12.2	15.0	17.3	19.4	22.9	27.4	128°	140°	147°
3/8"	•	•	•	20	4.4	11.5	16.3	20.0	23.1	25.8	30.6	36.5	130°	140°	146°
	•	•	•	25	4.9	14.4	20.4	25.0	28.9	32.3	38.2	45.6	130°	140°	146°
	•	•	•	30	5.4	17.3	24.5	30.0	34.6	38.7	45.8	54.8	130°	140°	146°
1/2"	•	•		40	6.2	23.1	32.7	40.0	46.2	51.6	61.1	73.0	132°	140°	145°
	•	•		50	7.0	28.9	40.8	50.0	57.7	64.5	76.4	91.3	132°	140°	145°
	•	•		60	7.6	34.6	49.0	60.0	69.3	77.5	91.7	110	132°	140°	145°
3/4"	•	•		75	8.6	43.3	61.2	75.0	86.6	96.8	115	137	133°	140°	144°
	•	•		150	12.2	86.6	122	150	173	194	229	274	135°	140°	144°